

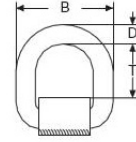

## Welding point SPAB



- Inele de prindere sudabile
- Punct de prindere cu fixare prin sudura – SPAB/ Grad 8
- Inel pentru ridicarea sarcinilor sudabil.
- Pentru sarcini asimetrice aduceți-va aminte ca capacitatea de ridicare trebuie redusa asa cum este aratat in tabelul de referinta.
  - Punctul de ancorare poate fi utilizat in conditii de siguranta pana la 20.000 de ridicari la capacitatea maxima
  - Coeficient de securitate 4
  - Inel testat 100% magnaflux
  - Fabricat din otel de inalta rezistenta
  - Acoperit cu vopsea epoxidica
  - Testat la 20.000 cicluri de utilizare



### DATE TEHNICE

- Ring to be welded for load lifting.
- For asymmetric loads remember that the capacity has to be reduced as shown in the reference table.
- -The anchorage clamp can be used safely up to maximum of 20.000 lifts with a full load
- Safety coefficient 4
- Ring tested 100 % magnaflux
- Made in high resistant steel
- Painted with epoxy paint
- Tested at 20.000 stress cycles

### Maße / Measurements

| Artikel ohne Feder<br>Article without spring | WLL<br>WLL | D    | T  | B   | Gewicht ca. kg<br>Weight approx. |
|--|------------|------|----|-----|----------------------------------|
| 31806011                                     | 1,12       | 13,5 | 41 | 66  | 0,32                             |
| 31808011                                     | 2,00       | 14,5 | 48 | 70  | 0,40                             |
| 31810011                                     | 3,15       | 17,0 | 48 | 79  | 0,65                             |
| 31813011                                     | 5,30       | 23,0 | 54 | 100 | 1,45                             |
| 31816011                                     | 8,00       | 27,0 | 66 | 123 | 2,60                             |
| 31822011                                     | 15,00      | 34,0 | 94 | 185 | 5,85                             |

### Tragfähigkeiten / WLLs



| Artikel ohne Feder<br>Article without spring | 0°<br>1Strang<br>Single leg | 0°<br>2Stränge<br>2 legs | 90°<br>1Strang<br>Single leg | 90°<br>2Stränge<br>2 legs | 0°-45° | 45°-60°<br>2Stränge<br>2 legs | Asym. | 0°-45° | 45°-60°<br>4Stränge<br>4 legs | Asym. |
|--|-----------------------------|--------------------------|------------------------------|---------------------------|--------|-------------------------------|-------|--------|-------------------------------|-------|
| 31806011                                     | 1,12                        | 2,24                     | 1,12                         | 2,24                      | 1,57   | 1,12                          | 1,12  | 2,35   | 1,68                          | 1,12  |
| 31808011                                     | 2,00                        | 4,00                     | 2,00                         | 4,00                      | 2,80   | 2,00                          | 2,00  | 4,20   | 3,00                          | 2,00  |
| 31810011                                     | 3,15                        | 6,30                     | 3,15                         | 6,30                      | 4,41   | 3,15                          | 3,15  | 6,62   | 4,73                          | 3,15  |
| 31813011                                     | 5,30                        | 10,60                    | 5,30                         | 10,60                     | 7,42   | 5,30                          | 5,30  | 11,13  | 7,95                          | 5,30  |
| 31816011                                     | 8,00                        | 16,00                    | 8,00                         | 16,00                     | 11,20  | 8,00                          | 8,00  | 16,80  | 12,00                         | 8,00  |
| 31822011                                     | 15,00                       | 30,00                    | 15,00                        | 30,00                     | 21,00  | 15,00                         | 15,00 | 31,50  | 22,50                         | 15,00 |

Total Race Impex SRL J40/20761/2006 , RO 19794573 , Bucuresti, sector 6 , Bulevardul Uverturii , nr.69A, cod:060933 Mobil:0728305610 / 0728305611 / 0728305612; fax: 0214301206;tel/fax :0314201202 E-mail:info@totalrace.ro;vanzari@totalrace.ro

Website:www.totalrace.ro , www.lanturideridicare.ro , www.chingimacarale.ro , www.benziambalare.ro , www.banadaancorare.rowww.lanturichingi.ro , www.carligemacarale.ro , www.echipamentemacara.ro , www.benebeton.ro , www.clestiridicare.ro .